

**2510 LAKESIDE DR** HIGHLAND, MI 48356-2430 (Property Address)

Parcel Number: H -11-13-179-005

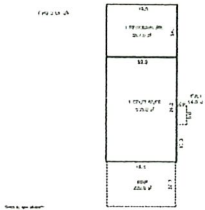

Item 1 of 1

0 Images / 1 Sketch

**Property Owner: D'ABATE, ANGELO****Summary Information**

## &gt; Residential Building Summary

- Year Built: 1952
- Full Baths: 3
- Sq. Feet: 1,884
- Bedrooms: 3
- Half Baths: 0

- > Assessed Value: \$105,910 | Taxable Value: \$87,090
- > Property Tax information found
- > 5 Building Department records found

**RECEIVED****Owner and Taxpayer Information****MAY 06 2025****Owner**

D'ABATE, ANGELO  
533 JOHN R  
MILFORD, MI 48381-1873

**Taxpayer**

SEE OWNER INFORMATION

**HIGHLAND TWP  
PLANNING DEPT**

**Legal Description**

T3N, R7E, SEC 13 SUNRISE HEIGHTS ON WHITE LAKE LOT 18, ALSO LOT 19 EXC S 10 FT

**Other Information****Recalculate amounts using a different Payment Date**

You can change your anticipated payment date in order to recalculate amounts due as of the specified date for this property.

Enter a Payment Date

5/5/2025

Recalculate

**Tax History**

**\*\*Note:** On March 1 at 12:00 AM, Summer and Winter local taxes become ineligible for payment at the local unit.

Year	Season	Total Amount	Total Paid	Last Paid	Total Due	
2024	Winter	\$1,458.35	\$1,458.35	02/25/2025	\$0.00	
2024	Summer	\$3,525.26	\$3,525.26	08/13/2024	\$0.00	
2023	Winter	\$1,377.15	\$1,377.15	02/06/2024	\$0.00	
2023	Summer	\$1,867.51	\$1,867.51	08/28/2023	\$0.00	
2022	Winter	\$1,265.62	\$0.00		<b>\$1,265.62</b>	<b>** Read Note(s) Above</b>
2022	Summer	\$1,778.56	\$1,778.56	07/26/2022	\$0.00	
2021	Winter	\$1,033.20	\$0.00		<b>\$1,033.20</b>	<b>** Read Note(s) Above</b>
2021	Summer	\$2,430.75	\$2,430.75	07/09/2021	\$0.00	
2020	Winter	\$1,019.71	\$1,019.71	12/16/2020	\$0.00	
2020	Summer	\$2,404.41	\$2,404.41	07/30/2020	\$0.00	

**\*\*Disclaimer:** BS&A Software provides BS&A Online as a way for municipalities to display information online and is not responsible for the content or accuracy of the data herein. This data is provided for reference only and WITHOUT WARRANTY of any kind, expressed or inferred. Please contact your local municipality if you believe there are errors in the data. If you are experiencing general issues using the BS&A Online website please contact BSA Online Support at [BSAOnlineSupport@bsasoftware.com](mailto:BSAOnlineSupport@bsasoftware.com) or 517-641-8900.